

Victorian Heritage Database Report
FORMER BLACKSMITH'S COTTAGE AND SHOP

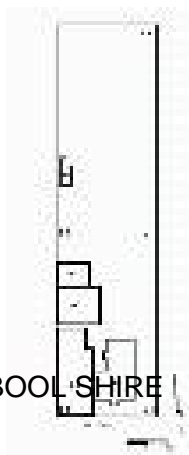

Location:

100-102 MAIN STREET BACCHUS MARSH, MOORABOOL SHIRE

Heritage Status / Level of Significance:

Registered

Victorian Heritage Register (VHR) Number: H0462

Listing Authority: VHR

Heritage Overlay Number: HO8

Statement of Significance:

Located at the junction of the Government Road to Maddingley and the main Government Road from Melbourne to Ballarat, the site has been occupied by a blacksmith since 1852 and possibly as early as 1850. The complex is of major

historic importance because of its direct associations with the function of Bacchus Marsh as a staging point along the "Gold" Road from Melbourne to Ballarat. The site was in continuous use as a blacksmith and wheelwright's premises and cottage until 1940 with various additions occurring until c.1930. It was the last "smithy" to survive in the town.

The cottage is described as constructed of stone in 1852, however, the rear timber section which abuts the stone section remaining posts suggesting that the stone wall was built later. The structure of the rear timber rooms and verandah is interesting in several aspects:

- * the morticed heads to the doors, suggesting construction prior to the establishment of the Blacksmith's shop where nails are common;
- * the lack of a ceiling although in 1975 the calico lining was still in place;
- * partial lining to interior walls;
- * beaded profile weatherboards.

The blacksmith's shop is the second on the site but is of great importance in maintaining the continuity of function and historical associations of the complex with the earliest gold rush days and possibly the pre-gold pastoral settlement of the area.

Heritage Study / Consultant	
Construction Date Range	1877 -
Architect / Designer	
Municipality	MOORABOOL SHIRE
Other names	
Hermes number	49
Property number	

This place/object may also be State heritage listed. Check the Victorian Heritage Database. For further details, contact the local Council or go to Planning Schemes Online