

Victorian Heritage Database Report
MILTON

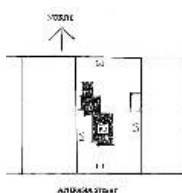

Location:

14 APHRASIA STREET NEWTOWN, Greater Geelong City

Heritage Status / Level of Significance:

Registered

Victorian Heritage Register (VHR) Number: H1164

Listing Authority: VHR

Heritage Overlay Number: HO202

Statement of Significance:

Milton was erected in 1857-58 for prominent Geelong pharmacist and politician Charles Kernot. It was designed by leading Geelong architects Backhouse and Reynolds in Renaissance Revival style. It is a two storey asymmetrical stuccoed masonry town house with hipped roof of slate, bracketed eaves and rusticated quoins.

Milton is of architectural and historical significance to the State of Victoria.

Milton is important as an extraordinary example of the work of leading Geelong architects Backhouse and Reynolds. It is also a particularly fine example of an elegant Renaissance Revival town house of the mid nineteenth century.

Milton is important for its association with the Kernot family, with the house being built for Charles Kernot, chemist, stationer, councillor and politician, whose eldest son became the first graduate in civil engineering at Melbourne University and also became that institution's first professor of engineering.

[Source: Report to the Minister.]

Heritage Study / Consultant	
Construction Date Range	1857 - 1858
Architect / Designer	Backhouse & Reynolds
Municipality	GREATER GEELONG CITY
Other names	
Hermes number	4799
Property number	

This place/object may also be State heritage listed. Check the Victorian Heritage Database. For further details, contact the local Council or go to Planning Schemes Online