

Victorian Heritage Database Report
ASHBY PRESBYTERY OF ST PETER AND ST PAUL

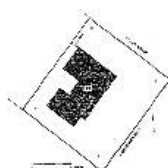

Location:

1 MALONE STREET GEELONG, Greater Geelong City

Heritage Status / Level of Significance:

Registered

Victorian Heritage Register (VHR) Number: H1112

Listing Authority: VHR

Heritage Overlay Number: HO99

Statement of Significance:

What is significant?

Ashby Presbytery of St Peter and St Paul, a two storey brick and stucco building a balcony surmounted by gables to the front and side, was built in 1914-15 by E. Searle to the plans of architects Herbert Black and TD

Slevin.

How is it significant?

Ashby Presbytery is of architectural significance to Victoria.

Why is it significant?

Ashby Presbytery, described by the contemporary press as "modern Dutch style", is an extraordinary example of an architectural style. The Dutch colonial style residence with its eclectic elements including decorative motifs, Dutch gables and Arts and Crafts details such as the staircase is a style rarely found in Victoria, although it is reminiscent of the Dutch colonial buildings of South East Asia.

Heritage Study / Consultant	
Construction Date Range	1915 -
Architect / Designer	
Municipality	GREATER GEELONG CITY
Other names	
Hermes number	1923
Property number	

This place/object may also be State heritage listed. Check the Victorian Heritage Database. For further details, contact the local Council or go to Planning Schemes Online