

# FORMER TRAVELLERS REST INN



FORMER TRAVELLERS  
REST INN SOHE 2008



former travellers rest inn  
batesford front elevation  
publication



former travellers rest inn  
batesford side view oct1985

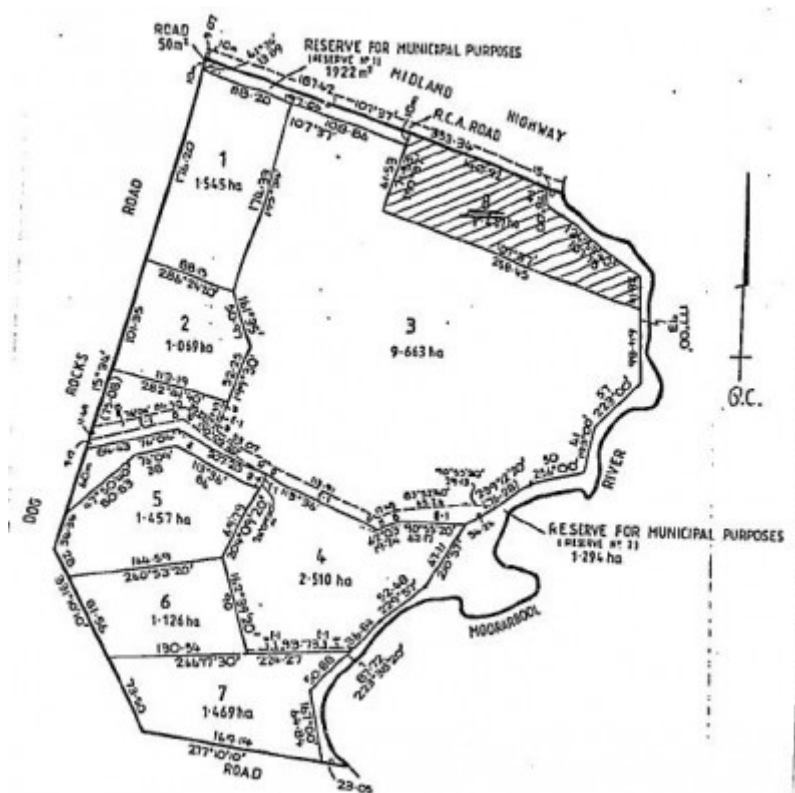

h00846 plan h0846

## Location

750 MIDLAND HIGHWAY BATESFORD, GREATER GEELONG CITY

## Municipality

## Level of significance

Registered

## Victorian Heritage Register (VHR) Number

H0846

## Heritage Overlay Numbers

HO44

## VHR Registration

February 6, 1991

## Heritage Listing

Victorian Heritage Register

---

## Statement of Significance

Last updated on - July 1, 1999

The former Travellers Rest Inn was erected in 1849 for licensee John Primrose. This rectangular plan Colonial Georgian structure of rendered rubble granite was converted to a residence in 1865 for Jacob Hammerli who acquired the inn and surrounding Paradise 4 Vineyard. The Travellers Rest Inn is the oldest surviving building in Batesford and one of the earliest constructed wayside inns in Victoria. This building which was strategically located at the ford crossing place of the Moorabool river served as a wayside inn for only a short time as the opening of the Ballarat Geelong railway line in April 1862 deprived the proprietors of most of the overnight custom. For many years the building was associated with the vineyards operated by Jacob Hammerli a noted district vigneron.

## Permit Exemptions

### General Exemptions:

General exemptions apply to all places and objects included in the Victorian Heritage Register (VHR). General exemptions have been designed to allow everyday activities, maintenance and changes to your property, which don't harm its cultural heritage significance, to proceed without the need to obtain approvals under the Heritage Act 2017.

Places of worship: In some circumstances, you can alter a place of worship to accommodate religious practices without a permit, but you must [notify](#) the Executive Director of Heritage Victoria before you start the works or activities at least 20 business days before the works or activities are to commence.

Subdivision/consolidation: Permit exemptions exist for some subdivisions and consolidations. If the subdivision or consolidation is in accordance with a planning permit granted under Part 4 of the *Planning and Environment Act 1987* and the application for the planning permit was referred to the Executive Director of Heritage Victoria as a determining referral authority, a permit is not required.

Specific exemptions may also apply to your registered place or object. If applicable, these are listed below.

Specific exemptions are tailored to the conservation and management needs of an individual registered place or object and set out works and activities that are exempt from the requirements of a permit. Specific exemptions prevail if they conflict with general exemptions.

Find out more about heritage permit exemptions [here](#).

Construction dates        1849,  
Heritage Act Categories   Registered place,  
Hermes Number            90  
Property Number

---

## History

Associated People:

## Extent of Registration

### AMENDMENT OF REGISTER OF HISTORIC BUILDINGS

Historic Building No. 846-

the former Traveller's Rest Inn, Batesford, Shire of Bannockburn.

(All buildings and land being Lot 8 on Plan of Subdivision No. 211523F in the Parish of Gheringhap, entered in the Register Book Certificate of Title Volume 9820 Folio 608 as shown hatched on Plan A endorsed by the Chairperson, Historic Buildings Council and held by the Director, Historic Buildings Council.)

[*Victoria Government Gazette* No. G5 6 February 1991 p.247]

*This place/object may be included in the Victorian Heritage Register pursuant to the Heritage Act 2017. Check the Victorian Heritage Database, selecting 'Heritage Victoria' as the place source.*

*For further details about Heritage Overlay places, contact the relevant local council or go to Planning Schemes Online <http://planningschemes.dpcd.vic.gov.au/>*