

# ST MARKS ON THE HILL



ST MARKS ON THE HILL  
SOHE 2008



1 st marks on the hill leopold  
front view



st marks on the hill leopold  
rear view



st marks on the hill leopold  
vicarage

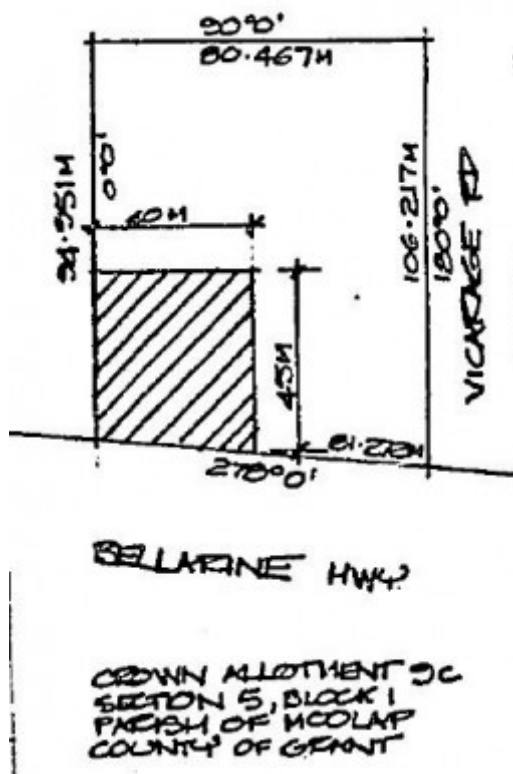

H0776 H0776 plan

---

## Location

715-729 BELLARINE HIGHWAY LEOPOLD, GREATER GEELONG CITY

## Municipality

GREATER GEELONG CITY

## Level of significance

Registered

## Victorian Heritage Register (VHR) Number

H0776

## Heritage Overlay Numbers

HO288

## VHR Registration

June 27, 1990

## Heritage Listing

Victorian Heritage Register

---

## Statement of Significance

Last updated on - July 1, 1999

The small bluestone church at Leopold, or the village of Kensington, as it was known originally, was built between 1859 and 1862, from the designs of the distinguished Geelong architect, Edward Prowse. It was identified in Allan Willingham's study for the Geelong regional commission as of state significance and is on the registers of the national trust and the national estate.

St Mark's On The Hill is of bluestone in the Early English Gothic style, with a simple rectangular plan and steeply gabled roof of slate. The roof is supported internally on curved timber trusses and is lined with beaded-edge timber boarding. The walls are plastered and there is a timber floor. The red brick sanctuary was added in 1919 and the gabled bluestone entry porch in 1931.

The timber panelling to the interior of the church was added in 1935, with the new timber panelling to the nave being completed in 1953. St Mark's has both architectural and historical significance for a number of reasons: ‘

1. It is a good example of a small bluestone western district church based on the design of a typical English village church of the period. This was a most appropriate design for the parish church at Kensington a small rural village in colonial Victoria.

2. It is regarded as one of the finest works of the distinguished Geelong architect, Edward Prowse and one of his most unusual designs. He was an architect who usually designed buildings on a much grander scale, such as the hermitage at Newtown for George Armytage, June (1859-60) and Ingleby Homestead for George Armytage, Senr (1860). Prowse is also thought to have designed the classical bluestone Carranballac homestead at Skipton for

the influential Scots pioneer settler Andrew Chirnside in the middle 1860s.

3. Constructed between 1859 and 1862, St Marks On The Hill played an important role in the early history of the Anglican Church in the Geelong district and is regarded as the mother church of Bellarine Peninsula Anglicans.

## Permit Exemptions

### General Exemptions:

General exemptions apply to all places and objects included in the Victorian Heritage Register (VHR). General exemptions have been designed to allow everyday activities, maintenance and changes to your property, which don't harm its cultural heritage significance, to proceed without the need to obtain approvals under the Heritage Act 2017.

**Places of worship:** In some circumstances, you can alter a place of worship to accommodate religious practices without a permit, but you must [notify](#) the Executive Director of Heritage Victoria before you start the works or activities at least 20 business days before the works or activities are to commence.

**Subdivision/consolidation:** Permit exemptions exist for some subdivisions and consolidations. If the subdivision or consolidation is in accordance with a planning permit granted under Part 4 of the *Planning and Environment Act 1987* and the application for the planning permit was referred to the Executive Director of Heritage Victoria as a determining referral authority, a permit is not required.

Specific exemptions may also apply to your registered place or object. If applicable, these are listed below. Specific exemptions are tailored to the conservation and management needs of an individual registered place or object and set out works and activities that are exempt from the requirements of a permit. Specific exemptions prevail if they conflict with general exemptions.

Find out more about heritage permit exemptions [here](#).

Construction dates	1859,
Architect/Designer	Prowse, Edward,
Heritage Act Categories	Registered place,
Hermes Number	649
Property Number	

---

## History

Associated People:

## Extent of Registration

AMENDMENT OF REGISTER OF HISTORIC BUILDINGS

Historic Building No. 776.

St Marks on the Hill, Bellarine Highway, Leopold.

(To the extent of the whole of the building excluding the 1919 red brick addition and all of the land in the area shown hatched on the attached plan, which is part of Crown Allotment 9C, Section 5, Block One, Parish of

Moolap, County of Grant).

[Victoria Government Gazette No. G25 27 June 1990 p.1971]

*This place/object may be included in the Victorian Heritage Register pursuant to the Heritage Act 2017. Check the Victorian Heritage Database, selecting 'Heritage Victoria' as the place source.*

*For further details about Heritage Overlay places, contact the relevant local council or go to Planning Schemes Online <http://planningschemes.dpcd.vic.gov.au/>*