

MILTON



MILTON HOUSE SOHE 2008



1 milton house aphrasia
street geelong verandah

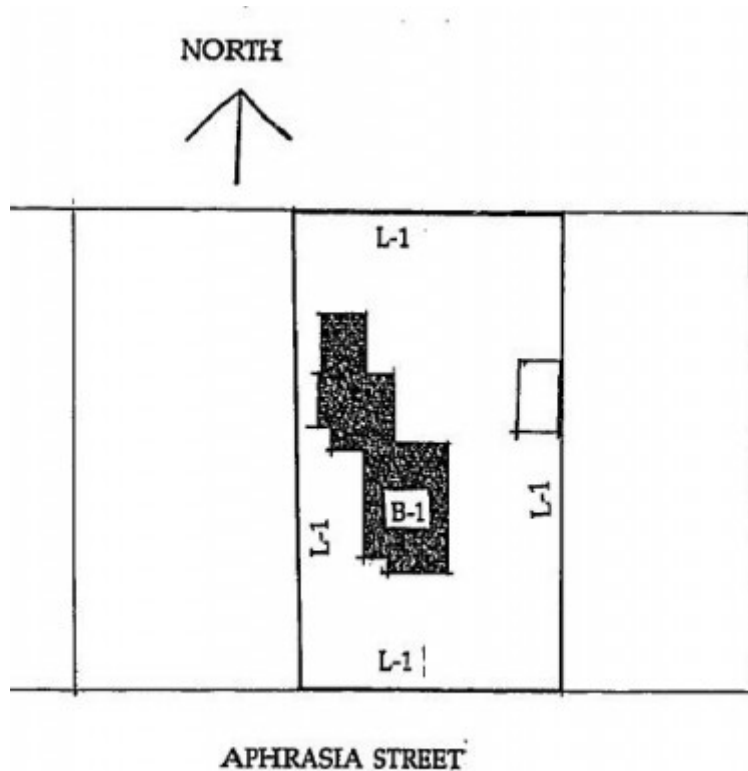

h01164 plan h1164

Location

14 APHRASIA STREET NEWTOWN, GREATER GEELONG CITY

Municipality

GREATER GEELONG CITY

Level of significance

Registered

Victorian Heritage Register (VHR) Number

H1164

Heritage Overlay Numbers

HO202

VHR Registration

April 18, 1996

Heritage Listing

Victorian Heritage Register

Statement of Significance

Last updated on - May 6, 1999

Milton was erected in 1857-58 for prominent Geelong pharmacist and politician Charles Kernot. It was designed by leading Geelong architects Backhouse and Reynolds in Renaissance Revival style. It is a two storey asymmetrical stuccoed masonry town house with hipped roof of slate, bracketed eaves and rusticated quoins.

Milton is of architectural and historical significance to the State of Victoria.

Milton is important as an extraordinary example of the work of leading Geelong architects Backhouse and Reynolds. It is also a particularly fine example of an elegant Renaissance Revival town house of the mid nineteenth century.

Milton is important for its association with the Kernot family, with the house being built for Charles Kernot, chemist, stationer, councillor and politician, whose eldest son became the first graduate in civil engineering at Melbourne University and also became that institution's first professor of engineering.

[Source: Report to the Minister.]

Permit Exemptions

General Exemptions:

General exemptions apply to all places and objects included in the Victorian Heritage Register (VHR). General exemptions have been designed to allow everyday activities, maintenance and changes to your property, which don't harm its cultural heritage significance, to proceed without the need to obtain approvals under the Heritage Act 2017.

Places of worship: In some circumstances, you can alter a place of worship to accommodate religious practices without a permit, but you must **notify** the Executive Director of Heritage Victoria before you start the works or activities at least 20 business days before the works or activities are to commence.

Subdivision/consolidation: Permit exemptions exist for some subdivisions and consolidations. If the subdivision or consolidation is in accordance with a planning permit granted under Part 4 of the *Planning and Environment Act 1987* and the application for the planning permit was referred to the Executive Director of Heritage Victoria as a determining referral authority, a permit is not required.

Specific exemptions may also apply to your registered place or object. If applicable, these are listed below. Specific exemptions are tailored to the conservation and management needs of an individual registered place or object and set out works and activities that are exempt from the requirements of a permit. Specific exemptions prevail if they conflict with general exemptions.

Find out more about heritage permit exemptions [here](#).

Construction dates	1857,
Architect/Designer	Backhouse & Reynolds,
Heritage Act Categories	Registered place,
Hermes Number	4799
Property Number	

Extent of Registration

AMENDMENT OF REGISTER OF HISTORIC BUILDINGS

Historic Building No. 1164:

Milton, 14 Aphrasia Street, Newtown, City of Greater Geelong.

Extent:

To the extent of:

1. All of the buildings known as Milton comprising the main house marked B-1 on Plan 605974 endorsed by the Chair, Historic Buildings Council and held by the Director, Historic Buildings Council.
 2. All of the land described in Certificate of Title Volume 5056 Folio 104, marked L-1 on Plan 605974 endorsed by the Chair, Historic Buildings Council and held by the Director, Historic Buildings Council.
- [*Victoria Government Gazette* No. G15 18 April 1996 p.956]

This place/object may be included in the Victorian Heritage Register pursuant to the Heritage Act 2017. Check the Victorian Heritage Database, selecting 'Heritage Victoria' as the place source.

For further details about Heritage Overlay places, contact the relevant local council or go to Planning Schemes Online <http://planningschemes.dpcd.vic.gov.au/>