

LATHAMSTOWE



LATHAMSTOWE SOHE
2008



1 lathamstowe gellibrand
street queenscliff front view

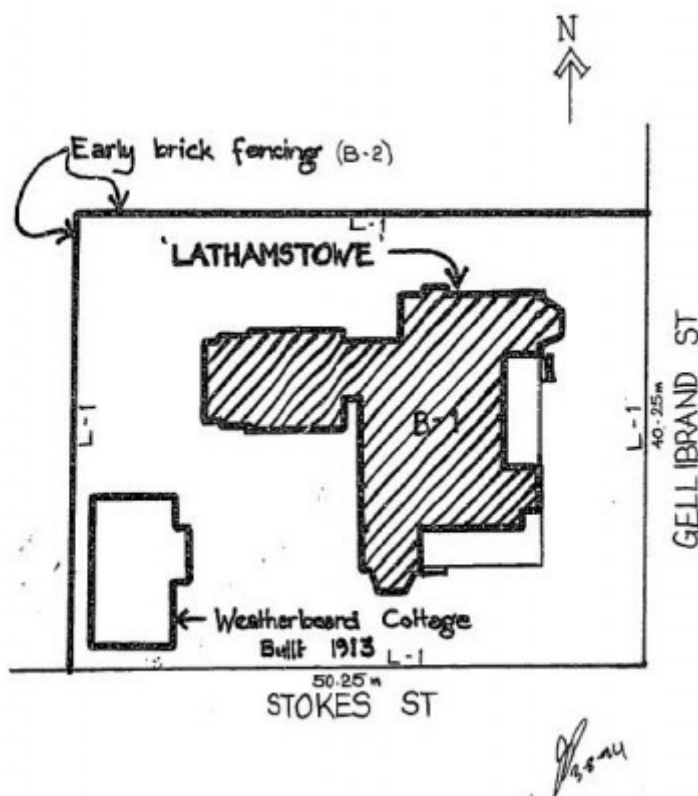

h01052 plan h1052

Location

44 GELLIBRAND STREET QUEENSCLIFF, QUEENSCLIFFE BOROUGH

Municipality

QUEENSCLIFFE BOROUGH

Level of significance

Registered

Victorian Heritage Register (VHR) Number

H1052

Heritage Overlay Numbers

HO23

VHR Registration

September 8, 1994

Heritage Listing

Victorian Heritage Register

Statement of Significance

Last updated on - May 5, 1999

Lathamstowe was built by brewer Edward Latham in 1882-83 to the design of William J Ellis, specifically for the use of the Anglican clergy as a seaside holiday residence. The two storeyed building consists of a pair of Italianate residences in a duplex arrangement combined with a corner tower.

Lathamstowe demonstrates the popularity of Queenscliff as a seaside resort in the nineteenth century and the popularity of the Italianate style for large and prestigious buildings in the late part of that century.

The scale of the building illustrates the social status of the Anglican clergy in the late nineteenth century and demonstrates the philanthropy of a wealthy layman whose gift enabled clergy and their families to holiday in a handsome and palatial building at a fashionable resort.

The building has an association with Edward Latham, brewer and business- man, who was a major figure in the development of brewing in Melbourne and who was related to another prominent Melbourne family, the Baillieu.

Permit Exemptions

General Exemptions:

General exemptions apply to all places and objects included in the Victorian Heritage Register (VHR). General exemptions have been designed to allow everyday activities, maintenance and changes to your property, which don't harm its cultural heritage significance, to proceed without the need to obtain approvals under the Heritage Act 2017.

Places of worship: In some circumstances, you can alter a place of worship to accommodate religious practices without a permit, but you must **notify** the Executive Director of Heritage Victoria before you start the works or activities at least 20 business days before the works or activities are to commence.

Subdivision/consolidation: Permit exemptions exist for some subdivisions and consolidations. If the subdivision or consolidation is in accordance with a planning permit granted under Part 4 of the *Planning and Environment Act*

1987 and the application for the planning permit was referred to the Executive Director of Heritage Victoria as a determining referral authority, a permit is not required.

Specific exemptions may also apply to your registered place or object. If applicable, these are listed below. Specific exemptions are tailored to the conservation and management needs of an individual registered place or object and set out works and activities that are exempt from the requirements of a permit. Specific exemptions prevail if they conflict with general exemptions.

Find out more about heritage permit exemptions [here](#).

Construction dates	1882,
Architect/Designer	Ellis, William J,
Heritage Act Categories	Registered place,
Hermes Number	1648
Property Number	

Extent of Registration

AMENDMENT OF REGISTER OF HISTORIC BUILDINGS

Historic Building No. 1052.

Lathamstowe, 44 Gellibrand Street, Queenscliff.

(To the extent of:

1. All of the building known as Lathamstowe, B-1 including the brick fencing B-2 and excluding the 1913 cottage, marked on Plan 6006533 endorsed by the Chairperson, Historic Buildings Council and held by the Director, Historic Buildings Council.

2. All of the land described in Certificate of Title Volume 1533 Folio 306506 marked L-1 on Plan 6006533 endorsed by the Chairperson, Historic Buildings Council and held by the Director, Historic Buildings Council.)

[Victoria Government Gazette No. G36 8 September 1994 pp.2436-2437]

This place/object may be included in the Victorian Heritage Register pursuant to the Heritage Act 2017. Check the Victorian Heritage Database, selecting 'Heritage Victoria' as the place source.

For further details about Heritage Overlay places, contact the relevant local council or go to Planning Schemes Online <http://planningschemes.dpcd.vic.gov.au/>